

Post date:

Monday, March 18, 2013 - 02:57

Last modified:

Sunday, December 14, 2014 - 14:20

Tossing ideas around with a forum member for a 30-Deg tool block to replace his compound on a small bench top lathe. This idea came to be because one of his lathes is a small bench top lathe with little rigidity and no thread dial. He is hoping to gain some rigidity back by locking the cross-slide, getting rid of the compound and tool post and using a more solid approach.

Anyway, heres some concepts.

Image Gallery:

- [View the full image](#)

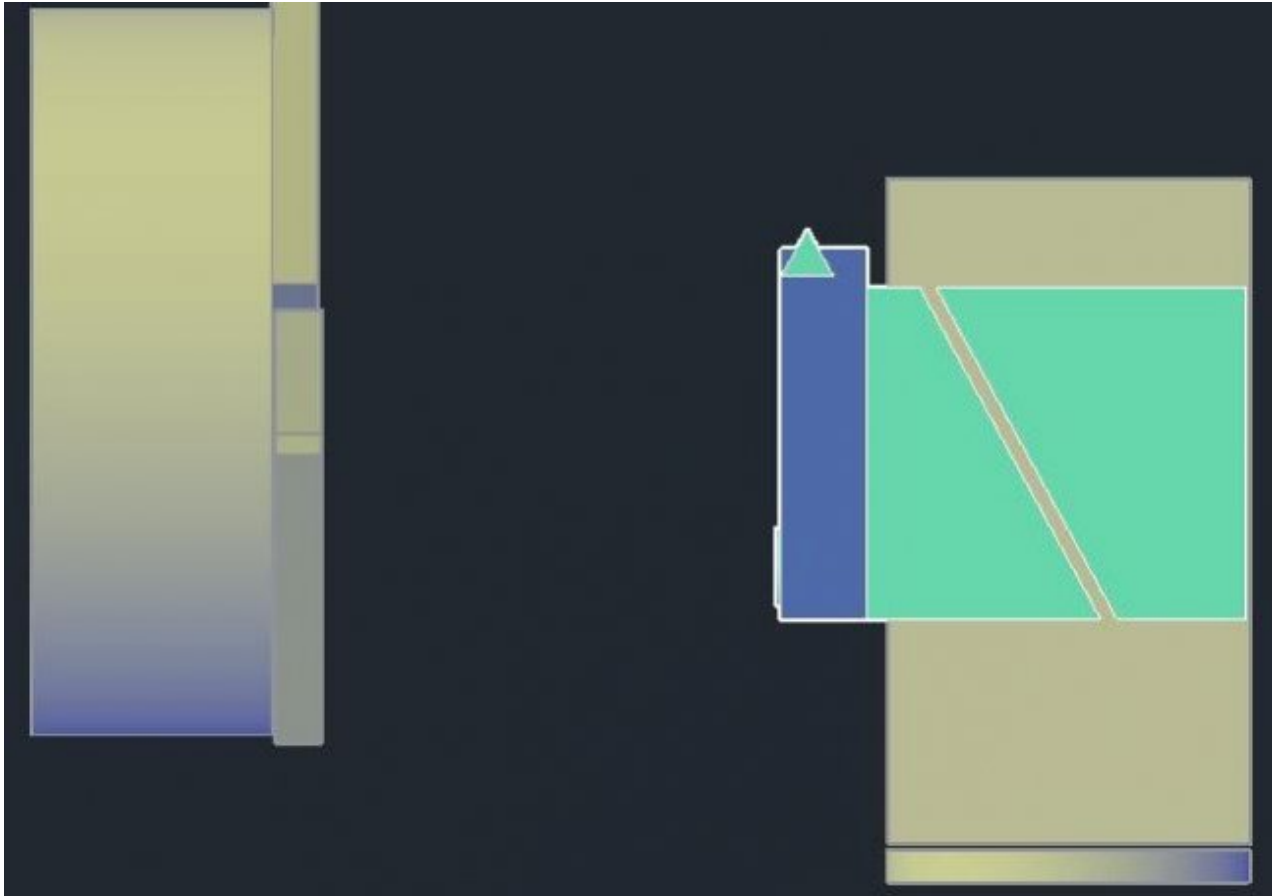

- [View the full image](#)

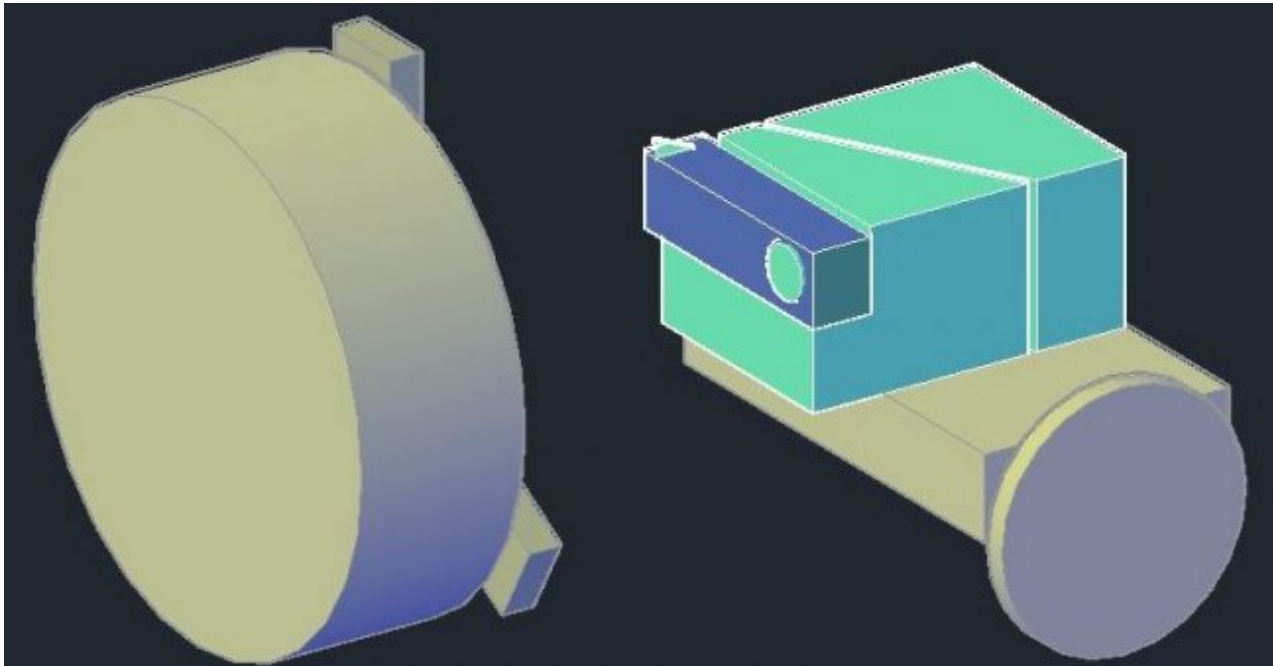

- [View the full image](#)

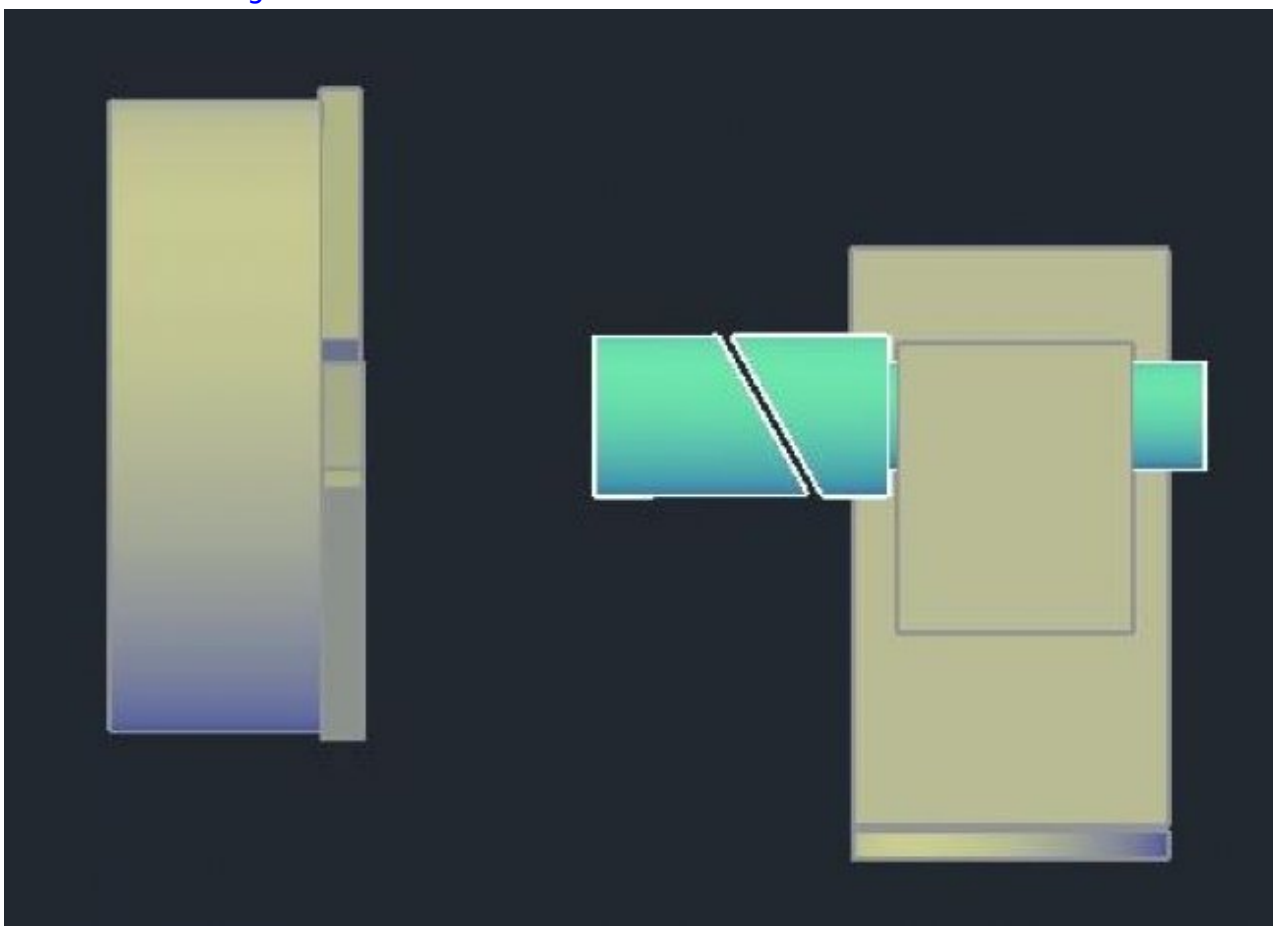

- [View the full image](#)

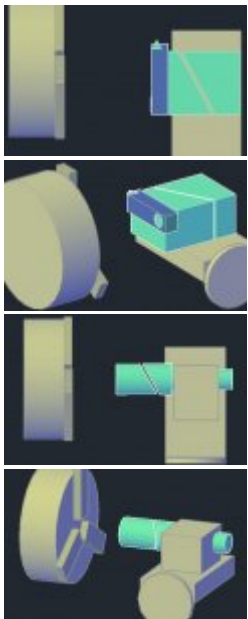
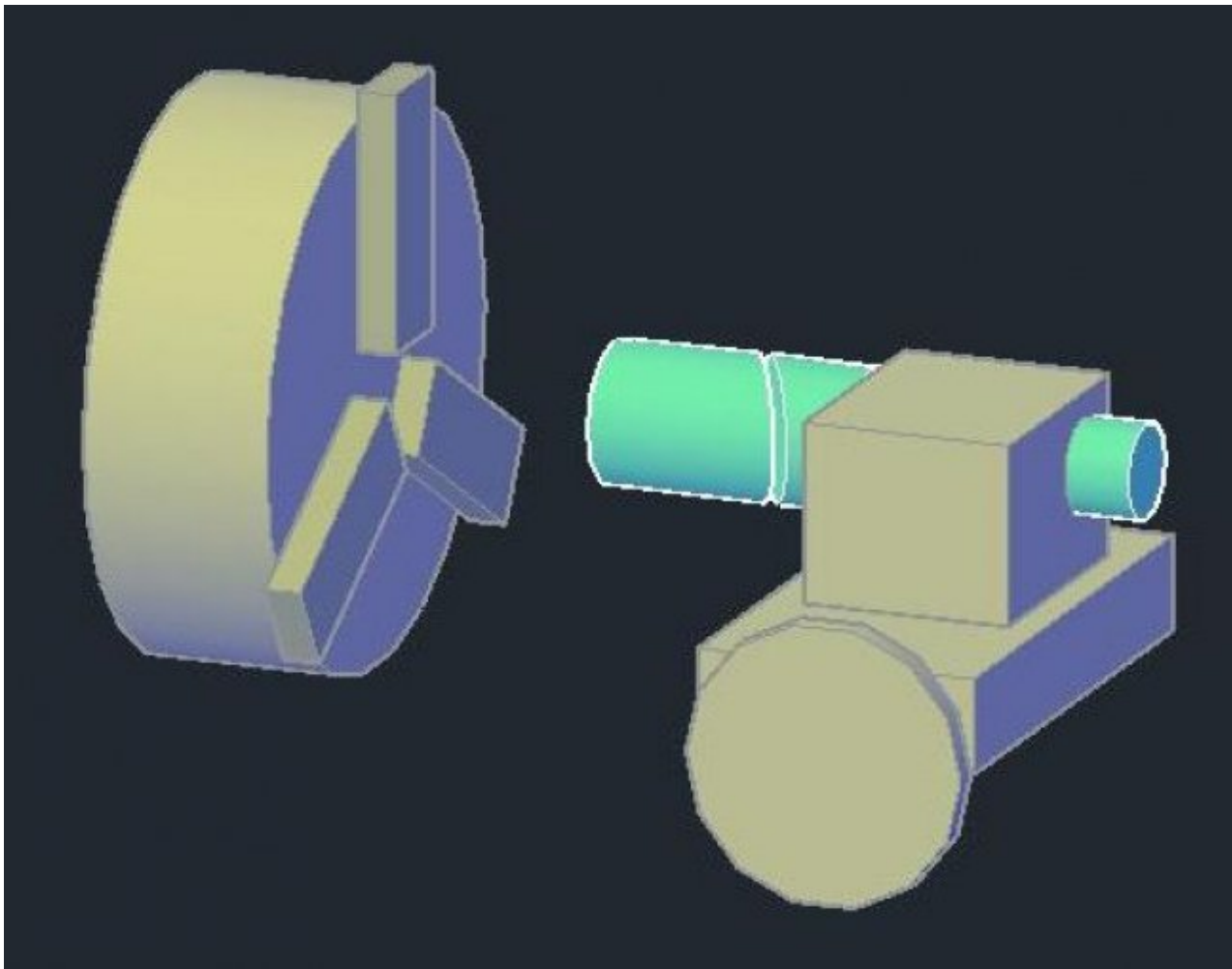

Mobile QR Barcodes:

[Save Article as PDF](#)



Current URL Address



Other site pages which link here:

Category:

[Tooling](#)

Tags:

[Models](#)

-  [Save page as PDF](#)
-